

# Data sheet

## FUEL TANK, 1000L & 3000L

### IDEAL USAGE

The Fuel Tank is a transportable, environmentally friendly double-walled fuel storage tank, that offers an efficient solution for onsite fueling and auxillary supply.

### APPLICATIONS

- Onsite fuel supply to refuel machinery from direct connection or rotary hand pump when needed.
- Able to connect quickly and efficiently to 2 diesel powered pieces of equipment consecutively.
- The fuel cubes can be transported safely to any location where fuel is required.



### WEIGHT AND MEASURES

Type	10TCG	30TCG
<b>Capacity</b> nominal / safe fill (95%)	949 / 902 litres	2,980 / 2,831 litres
<b>Dimensions</b> (L x W x H)	1,151 x 1,151 x 1,325mm	2,296 x 1,550 x 1,323 mm
<b>Weight</b> (empty / full)	540/ 1,442 KG	1,100/ 3,931 KG

**Design approvals** UL142, CAN/ULC-S601, UN DOT TRANSPORT, ADR, AS-1692 2006, ADG, VLAREM, KIWA

### FEATURES

- Lockable Equipment Cabinet
- Removable Inner Tank
- Galvanised Frame
- 110% Bunded
- Four Way Forklift Pockets
- Internal Baffles
- Fozmula Gauge for integration with UR Generators
- Overfill Protection

### PORTS CONFIGURATION

- 2" NPS Straight Thread Weld-In Tank Flange
- 3" Male Nipple with 3.0" Filler Cap/Emergency Vent
- 1.5" NPT Weld-In Tank Flange
- Hatch Lid - Lockbox
- Pump Mounting Bracket - UK
- 1/4" Weld-In Tank Flange Wit 1/4" NPT GTS Vent/WorkingVent
- Weld in Gauge Flange With Rochester Float Gauge
- 2" NPT Weld-in Tank Flange / Emergency Exit
- 0.5" BSP Coupling With Galvanised Plug / (Optional Manoterm Thermistor Overfill Protection Alarm)

### STANDARDS FOR SAFETY

UL 142 Steel Above Ground Tanks for Flamable and Combustable Liquids  
 CAN/ULC-S601 Shop fabricated Steel Above Ground Tanks for flamable and combustibile liquids  
 ADR  
 ADG Code  
 VLAREM II (Belgium)  
 KIWA (Holland)

### CONNECTIONS AND MATERIALS

#### Liquid Level Contents Gauge for tranferring of fuels

<b>Dimensions</b>	Length	Min. 150 mm, Max. 1200 mm
	Thread	1½" BSPT or 1½" NPT
	Weight	0.36 kg (Gauge Length, A = 600 mm)
<b>Materials</b>	Header	30% Glass filled Nylon 66
	Guide Rail	Anodised 6005-T5 Aluminium
	End Cap	30% Glass Filled Nylon 66
	End Cap Screw	A2 Stainless Steel
	Spiral	316 Stainless Steel
	Float	Polypropelene
	Dial Capsule	Polycarbonate
Leads	XLPE Sheathed	

# Technical drawing

30 TCG

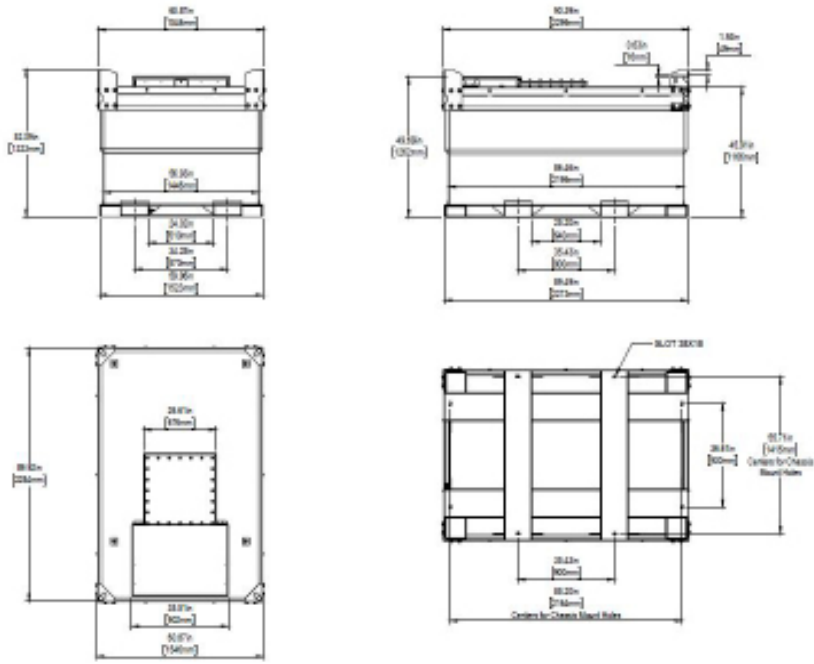

10 TCG

